

CLICK USB REAR™

USB Rechargeable Light
 Rechargeable Via Câble USB
 Aufladbare USB Leuchte
 Part# 7074412

Red indicator will remain on constant when charging.
 When charging is complete, the indicator will turn to green.

100% - 75% Battery capacity, fuel gauge is OFF.
 75% - 25% Battery capacity, green fuel gauge remains on constant.
 25% - 0% Battery capacity, red fuel gauge remains on constant.

MAKE SURE TO FULLY CHARGE LIGHT BEFORE FIRST USE

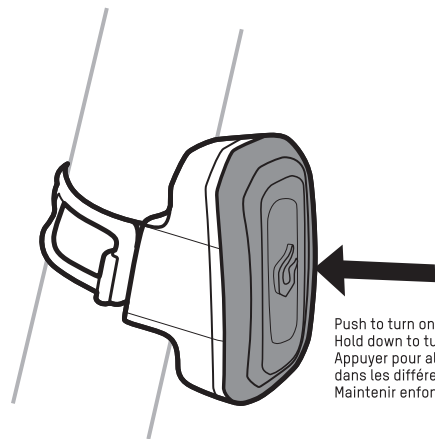

Push to turn on/Cycle Modes
 Hold down to turn off
 Appuyer pour allumer/cycler
 dans les différents Modes
 Maintenir enfoncé pour éteindre

Le voyant rouge restera allumé en permanence lors de la recharge.
 Lorsque la recharge est complète, l'indicateur devient vert.

De 100 % à 75 % de la capacité de la pile, la jauge de carburant est à l'arrêt.
 De 75 % à 25 % de la capacité de la pile, la jauge de carburant reste constamment verte.
 De 25 % à 0 % de la capacité de la pile, la jauge de carburant reste constamment rouge.

ASSUREZ-VOUS DE RECHARGER COMPLÈTEMENT LA LAMPE AVANT LA PREMIÈRE UTILISATION.

Die rote Leuchtanzeige leuchtet beim Laden durchgehend.
 Nach Abschluss des Ladevorgangs leuchtet die Anzeige grün.

100 % bis 75 % Ladestand, Ladestandsanzeige ist AUS.
 75 % bis 25 % Ladestand, grüne Ladestandsanzeige leuchtet dauerhaft.
 25 % bis 0 % Ladestand, rote Ladestandsanzeige leuchtet dauerhaft.

LADEN SIE DIE LEUCHE VOR DER ERSTEN VERWENDUNG VOLLSTÄNDIG AUF.

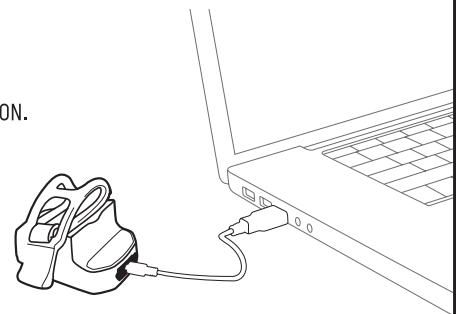

- * Ask your retailer for full warranty policy or visit www.blackburndesign.com/warranty
- * Demandez à votre détaillant tous les détails de la politique de garantie ou consultez le site www.blackburndesign.com/warranty
- * Wenden Sie sich bezüglich der Vollgarantie bitte an Ihren Einzelhändler oder besuchen Sie www.blackburndesign.com/warrant

FL 1 STANDARD	HIGH	STROBE
	20 LUMENS	20 LUMENS
	1.5 hrs	3 hrs
	7 cd	7 cd
	5 m	5 m
FL 1 STANDARD	FL 1 STANDARD	
	1m	

LIMITED LIFETIME WARRANTY
*RESTRICTIONS & CONDITIONS APPLY
2-YEAR WARRANTY

UK CA

CE

RoHS Compliant



- ▲ **WARNINGS:** Potential choking hazard to children. This light is extremely bright—do not aim directly into eyes. UK ONLY: When used for cycling, this light should be used in conjunction with a British Standard 6102/3 cycle light.
- ▲ **AVERTISSEMENT :** Danger possible d'étouffement pour les enfants. Cette lampe est extrêmement brillante – ne pas diriger le faisceau directement dans les yeux.
- ▲ **WARNING:** Potenzielle Erstickungsgefahr für Kinder. Dieses Licht ist extrem hell. Nicht direkt in die Augen richten!

Visit us at blackburndesign.com for product updates
 Visitez le site [Internet blackburndesign.com](http://blackburndesign.com) pour obtenir les mises à jour sur les produits
 Informationen über Produktverbesserungen finden Sie unter www.blackburndesign.com

Blackburn

Customer Service: 1-800-456-2355
Blackburndesign.com
 Printed in China

This equipment has been tested and found to comply with the limits for a Class B digital device, pursuant to Part 15 of the FCC Rules. These limits are designed to provide reasonable protection against harmful interference in a residential installation. This equipment generates, uses and can radiate radio frequency energy and, if not installed and used in accordance with the instructions, may cause harmful interference to radio communications. However, there is no guarantee that interference will not occur in a particular installation. If this equipment does cause harmful interference to radio or television reception, which can be determined by turning the equipment off and on, the user is encouraged to try to correct the interference by one or more of the following measures: • Reorient or relocate the receiving antenna. • Increase the separation between the equipment and receiver. • Connect the equipment into an outlet on a circuit different from that to which the receiver is connected. • Consult the dealer or an experienced radio/TV technician for help. Shielded interface cable must be used with the equipment in order to comply with the limits for a digital device pursuant to Subpart B of Part 15 of FCC Rules. Specifications and designs are subject to change without any notice or obligation on the part of the manufacturer.

DAYBLAZER 550™

USB Rechargeable Light
 Rechargeable Via Câble USB
 Aufladbare USB Leuchte
 Part# 7134751

Push to turn on/Cycle Modes
 Hold down to turn off
 Appuyer pour allumer/cycler
 dans les différents Modes
 Maintenir enfoncé pour éteindre

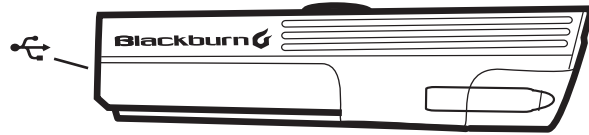
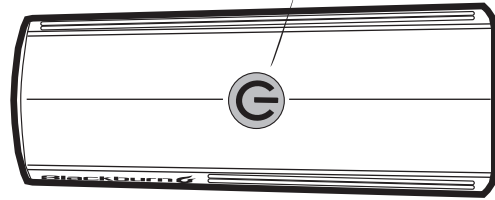

Plug into Micro USB port
 Plug into computer USB port
 Brancher sur le port USB
 Brancher sur le port USB de l'ordinateur

1. Push button to power on.
 2. Click to cycle modes.
 3. Hold down 1 second to power off.
- Light powers back on in the last mode used.

The light indicator will blink when charging. When charging is complete the light indicator with flash green.

GREEN = 100% to 75% Battery Capacity
 ORANGE = 75% to 25% Battery Capacity
 RED = <25% Battery Capacity

When battery capacity is 25-35 minutes or less, red indicator light will remain on constant until light reaches 0% or turns off in the selected mode.

MAKE SURE TO FULLY CHARGE LIGHT BEFORE FIRST USE

1. Appuyez sur le bouton pour allumer.
 2. Cliquez pour faire défiler les modes.
 3. Maintenez le bouton enfoncé pendant 1 seconde pour éteindre.
- La lampe se rallumera dans le dernier mode utilisé.

L'indicateur lumineux clignote pendant la charge. Quand la charge est complète, l'indicateur lumineux clignote en vert.

ERT = Capacité des piles de 100 % à 75 %
 ORANGE = Capacité des piles de 75 % à 25 %
 ROUGE = Capacité des piles < 25 %

Quand l'éclairage ne peut durer que 25 à 35 minutes ou moins, l'indicateur lumineux rouge reste constamment allumé jusqu'à ce que la capacité atteigne 0 % ou que la lampe s'éteigne dans le mode choisi.

VÉRIFIER QUE L'ÉCLAIRAGE EST TOTALEMENT CHARGÉ AVANT LE PREMIER USAGE

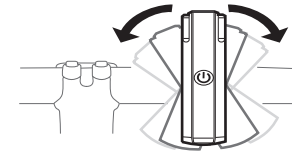
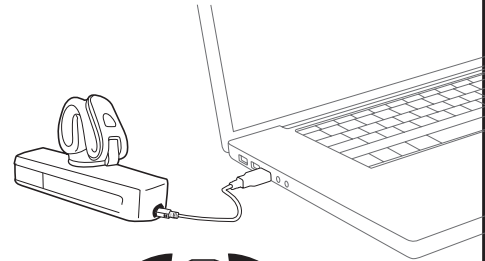

1. Druckknopf EIN.
2. Klicken, um Modi auszuführen.
3. Halten Sie 1 Sekunde AUS.

Beim Laden blinkt die Anzeige. Grünes Licht zeigt an, dass der Ladevorgang abgeschlossen ist.

RÜN = 100% bis 75% Batteriekapazität
 ORANGE = 75% bis 25% Batteriekapazität
 ROT = <25% Batteriekapazität

Beträgt die Batteriekapazität 25-35 Minuten oder weniger, bleibt das rote Licht ständig an, bis die Leuchte 0% erreicht oder sich im gewählten Modus abschaltet.

SICHERSTELLEN, DASS DIE LEUCHE VOR DEM ERSTEN GEBRAUCH VOLLSTÄNDIG GELADEN IST

FL 1 STANDARD	BLITZ	HIGH	LOW	PULSE	STROBE
	550 LUMENS	275 LUMENS	75 LUMENS	100 LUMENS	65 LUMENS
	1 hr	1.5 hrs	5 hrs	5.5 hrs	12 hrs
	1000 cd	380 cd	150 cd	175 cd	140 cd
	IP-67 Dust and Water Resistance				

LIMITED LIFETIME WARRANTY
*RESTRICTIONS & CONDITIONS APPLY
2-YEAR WARRANTY

▲ WARNINGS: Potential choking hazard to children. This light is extremely bright—do not aim directly into eyes. UK ONLY: When used for cycling, this light should be used in conjunction with a British Standard 6102/3 cycle light.

▲ AVERTISSEMENT : Danger possible d'étouffement pour les enfants. Cette lampe est extrêmement brillante – ne pas diriger le faisceau directement dans les yeux.

▲ WARNUNG: Potenzielle Erstickungsgefahr für Kinder. Dieses Licht ist extrem hell. Nicht direkt in die Augen richten!

Visit us at blackburndesign.com for product updates
 Visitez le site Internet blackburndesign.com pour obtenir les mises à jour sur les produits
 Informationen über Produktverbesserungen finden Sie unter www.blackburndesign.com

Blackburn

Customer Service: 1-800-456-2355
Blackburndesign.com
 Printed in China

**UK
CA**

CE

**RoHS
Compliant**



This equipment has been tested and found to comply with the limits for a Class B digital device, pursuant to Part 15 of the FCC Rules. These limits are designed to provide reasonable protection against harmful interference in a residential installation. This equipment generates, uses and can radiate radio frequency energy and, if not installed and used in accordance with the instructions, may cause harmful interference to radio communications. However, there is no guarantee that interference will not occur in a particular installation. If this equipment does cause harmful interference to radio or television reception, which can be determined by turning the equipment off and on, the user is encouraged to try to correct the interference by one or more of the following measures: - Reorient or relocate the receiving antenna. - Increase the separation between the equipment and receiver. - Connect the equipment into an outlet on a circuit different from that to which the receiver is connected. - Consult the dealer or an experienced radio/TV technician for help. Shielded interface cable must be used with the equipment in order to comply with the limits for a digital device pursuant to Subpart B of Part 15 of FCC Rules. Specifications and designs are subject to change without any notice or obligation on the part of the manufacturer.